

# SC32

## Components List: 32-Channel Semi-Chronic Microdrive System

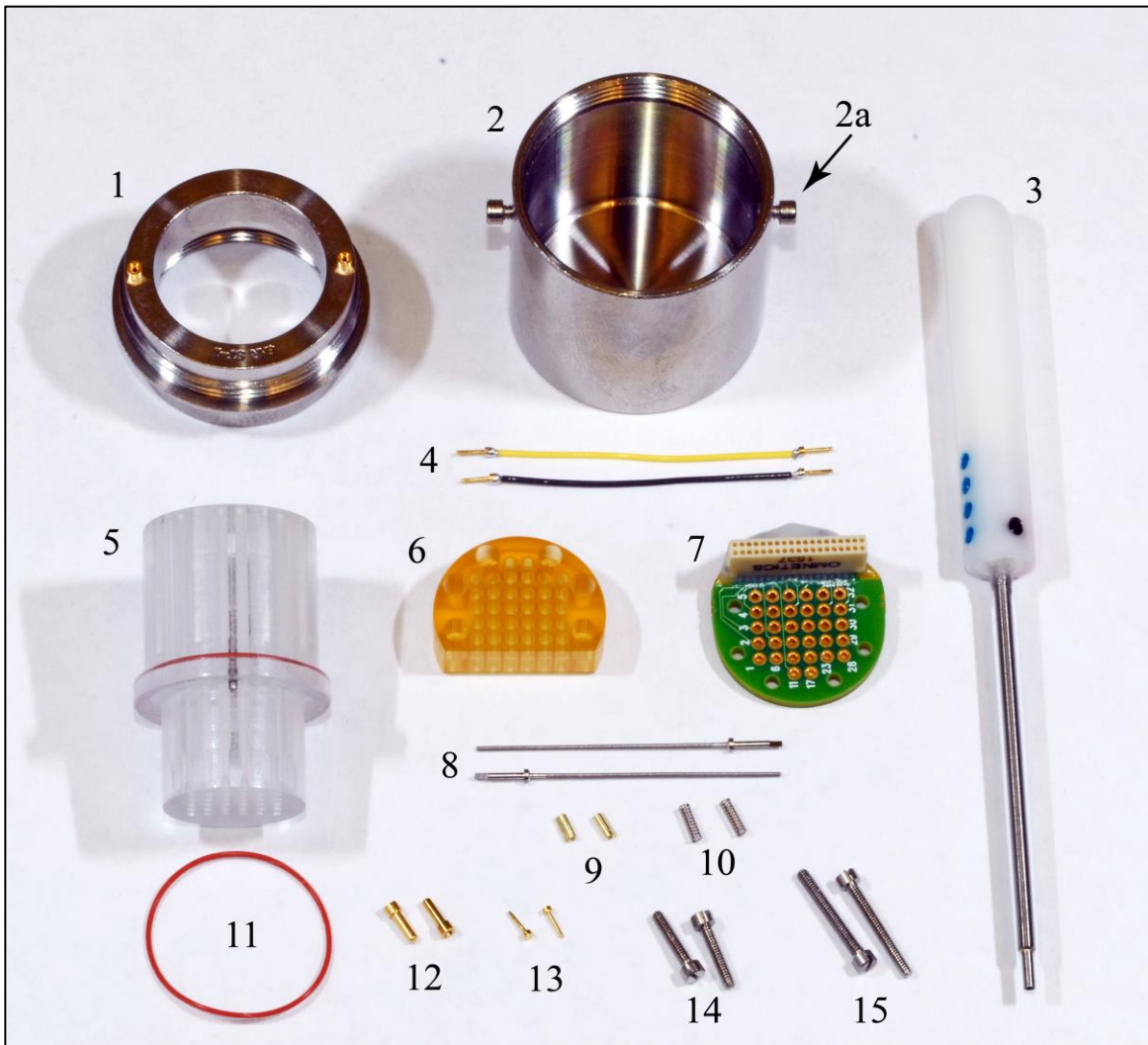

Item#	Part#	Description	Quantity/System
1.	RTC32	Retaining Cap	1
2.	PTC32	Protective Cap	1
2a.	S0-80x1/16	0-80 x 1/16" hex cap screw	4
3.	HCS D	Half-Circle Lead Screw Driver	3
4.	GND-C	Ground Jumper Cable	2
5.	AB32	Actuator Block	1
6.	SG32	Screw Guide	1
7.	PCB32	Printed Circuit Board	1
8.	S0.5unm-16mm	Half-Circle Lead Screw	32
9.	TDS	Tear Drop Shuttle	32
10.	CSR	Compression Spring	32
11.	ABOR	Actuator Block O-Ring	1
12.	GPIN-F	Female Grounding Pin	2
13.	GPIN-M	Male Grounding Pin	4
14.	S1.2-0.25	1.2 x 0.25" unmm screw	4
15.	S1.2-0.375	1.2 x 0.375" unmm screw	6
16.	HD 1.3x.05	Hex Driver (not shown)	2
17.	SD 1.5x40	Screwdriver (not shown)	2