

CONNECTOR

SCREWGUIDE

PCB

ACTUATOR  
BLOCK

ALIGNMENT PIN

[17.5mm]  
Ø 0.69in

[12.6mm]  
Ø 0.50in

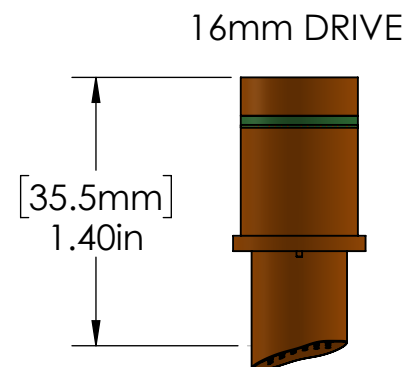

32mm DRIVE

42mm DRIVE

DRIVE NAME DENOTES MAXIMUM  
TRAVEL CAPABILITY.

32 INDEPENDENTLY MOVABLE ELECTRODES.  
1.5MM INTERELECTRODE SPACING.  
MATES WITH EITHER TANGENTIAL OR  
FORM-FITTING CHAMBER.

DIMENSIONS ARE IN [MM]  
AND INCHES

**GrayMatter Research**

TITLE:

**SC32 MICRODRIVE**

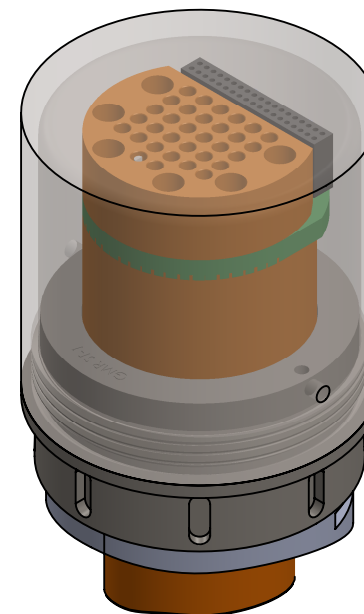
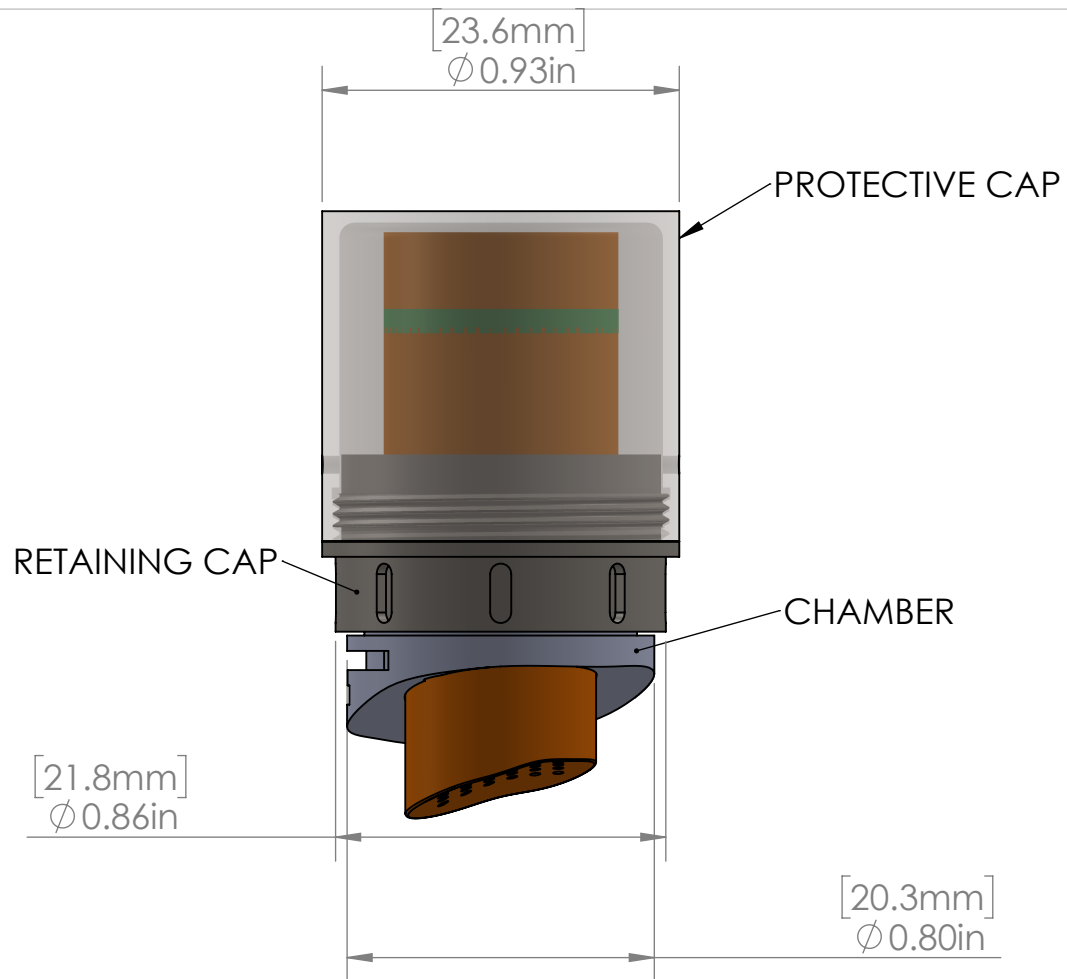

THE FORM FITTING CHAMBER IS DESIGNED TO SIT ON TOP OF SKULL AND THE FORM FITTING MICRODRIVE IS CONTOURED TO THE INSIDE SURFACE OF THE SKULL.

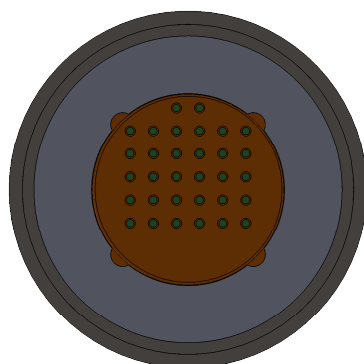

DIMENSIONS ARE IN [MM]  
AND INCHES

**GrayMatter Research**

TITLE:

**SC32 MICRODRIVE**

**BOTTOM VIEW OF ACTUATOR BLOCK SHOWING STANDARD ELECTRODE HOLE EXIT PATTERN**

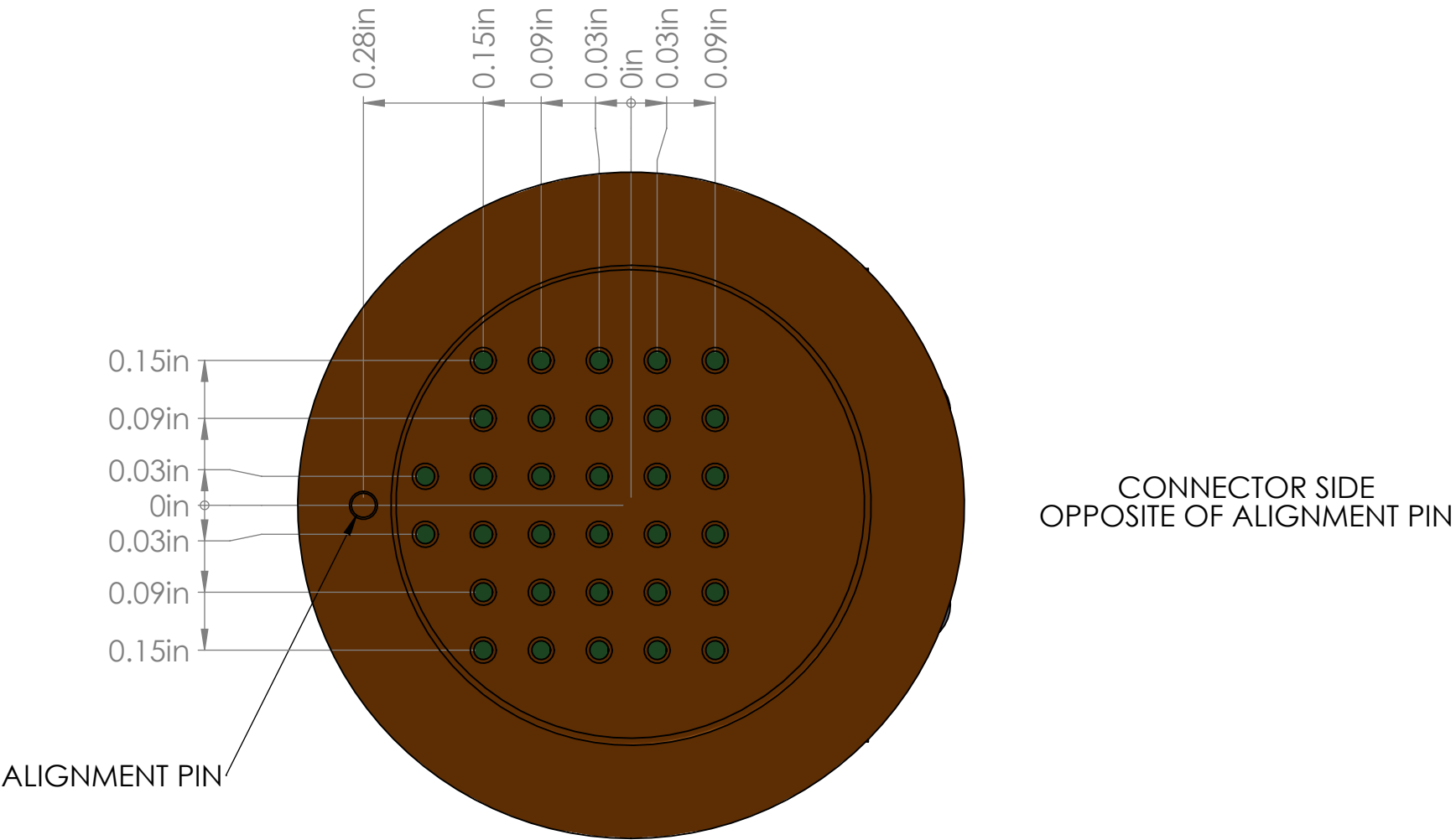

ALIGNMENT PIN

DIMENSIONS ARE IN [MM]  
AND INCHES

**GrayMatter Research**

TITLE: SC32-MICRODRIVE